



SMT Power Inductors

AM5022 SERIES

FEATURES

- Designed for low profile and high performance
- High energy storage and low resistance
- Ideal for DC-DC converter applications, such as pagers, notebook computers, PDA's, etc

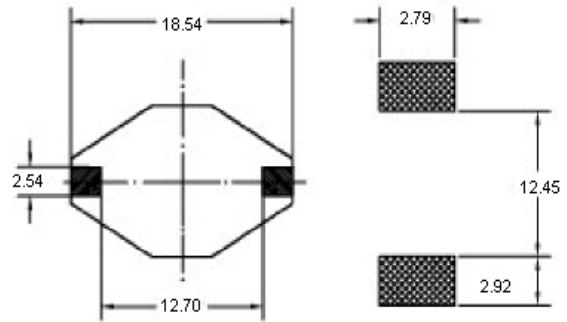
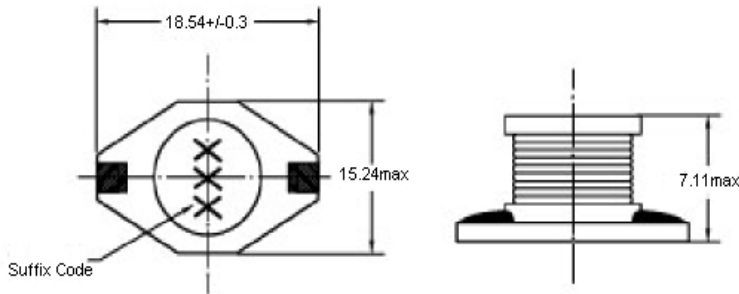

Pad Layout

Part No.	L (uhy)	DCR (mΩ)	I(sat)
AM5022-1R0M	1.0	9	20.00
AM5022-2R2M	2.2	14	16.00
AM5022-3R3M	3.3	18	14.00
AM5022-5R6M	5.6	20	12.00
AM5022-100M	10.0	31	10.00
AM5022-150M	15.0	36	8.00
AM5022-220M	22.0	47	7.00
AM5022-330M	33.0	66	5.50
AM5022-470M	47.0	86	4.50
AM5022-680M	68.0	130	3.50
AM5022-101M	100.0	190	3.00
AM5022-151M	150.0	250	2.60
AM5022-221M	220.0	380	2.40
AM5022-331M	330.0	560	1.90
AM5022-471M	470.0	850	1.40
AM5022-681M	680.0	1100	1.20
AM5022-102M	1000.0	1800	1.00

Ordering Code

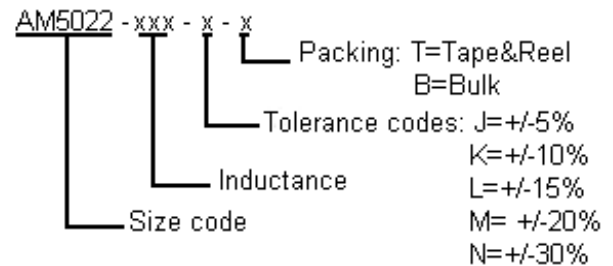

Notes:

- 1) Inductance measured at 100KHz. 0.1V
- 2) Isat: current at which inductance drops 10%
- 3) Temp rise at rated current: 40 deg C
- 4) Operating temp range: -40 to +85 deg C
- 5) Electrical specifications at 20 deg C